

SCHEDULE "B" TO
ZONING BY-LAW 2003-16
AS AMENDED,
OFFICE CONSOLIDATION 2010

TYENDINAGA
TOWNSHIP



THIS OFFICE CONSOLIDATION OF COMPREHENSIVE ZONING BY-LAW 03-16, AS AMENDED, IS FOR CONVENIENCE PURPOSES ONLY. PLEASE REFER TO THE ORIGINAL ZONING BY-LAW 03-16, AND ANY AMENDMENTS THERETO FOR ADDITIONAL INFORMATION. THIS CONSOLIDATION INCLUDES NEW MAPPING WHICH INCORPORATES ALL AMENDMENTS TO ZONING BY-LAW 03-16 TO JANUARY 2010. THE OFFICIAL SCHEDULES AND ZONING INFORMATION IS AVAILABLE AT THE MUNICIPAL OFFICE.

ONLY SPECIAL POLICY AREAS (E.G. MX-1) ARE LABELED TO DIFFERENTIATE THEM FROM ZONES (E.G. MX), WHICH ARE REPRESENTED BY THE COLOUR IN THE LEGEND.

AREAS WHERE AMENDMENTS TO 03-16 HAVE OCCURRED TO JANUARY 2010 ARE NOTED ON THE MAP WITH AN ASTERISK AND ARE ACCOMPANIED WITH THE BY-LAW NUMBER.

LOT PARCELS LINES ARE SHOWN.

ROADS ARE SHOWN AS A SOLID THICK BLACK LINE. ROAD OWNERSHIP OR MAINTENANCE LEVELS ARE NOT REPRESENTED.

PLOT DATE	ZB AMENDMENTS INCLUDED	INITIALS
MARCH 1 2010	MAY 2002 TO JAN 2010	N.B.

- * REZONING BY-LAW INDICATOR
- ENVIRONMENTALLY SENSITIVE LANDS
- ENVIRONMENTAL PROTECTION WETLAND
- ENVIRONMENTAL PROTECTION
- AGGREGATE RESOURCE AREA (EXTRACTIVE ACTIVE)
- PA - PERMANENT AGRICULTURE
- MA - MARGINAL AGRICULTURE
- RR - RURAL RESIDENTIAL
- RU - RURAL EXCEPTION
- LSR - LIMITED SERVICE RESIDENTIAL
- WR - WATERFRONT RESIDENTIAL
- RI - RESIDENTIAL SECOND DENSITY
- R2 - RESIDENTIAL SECOND DENSITY
- MR - MULTIPLE RESIDENTIAL
- MHR - MOBILE HOME RESIDENTIAL
- RC - RURAL COMMERCIAL
- UC - URBAN COMMERCIAL
- RRC - RECREATION/RESORT COMMERCIAL
- RI - RURAL INDUSTRIAL
- UI - URBAN INDUSTRIAL
- MX - MINERAL EXTRACTIVE
- M - MINING
- WD - WASTE DISPOSAL
- CF - COMMUNITY FACILITY
- GH - GROUP HOME
- OS - OPEN SPACE
- RA - ROAD ALLOWANCE

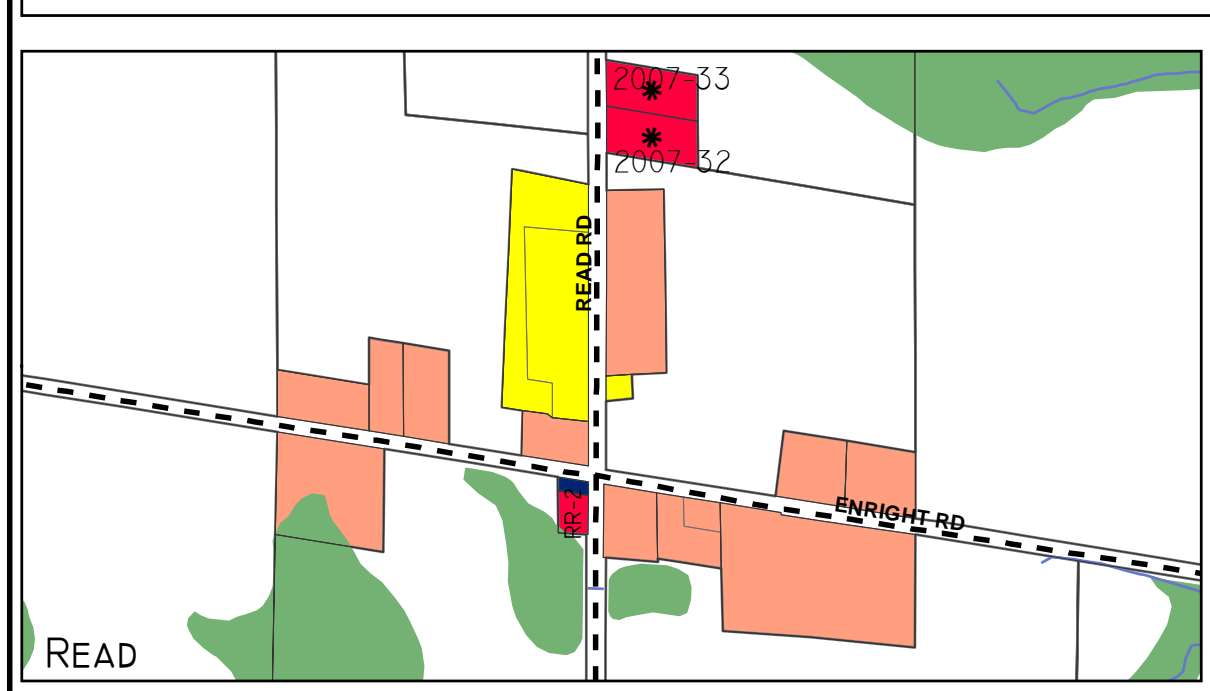
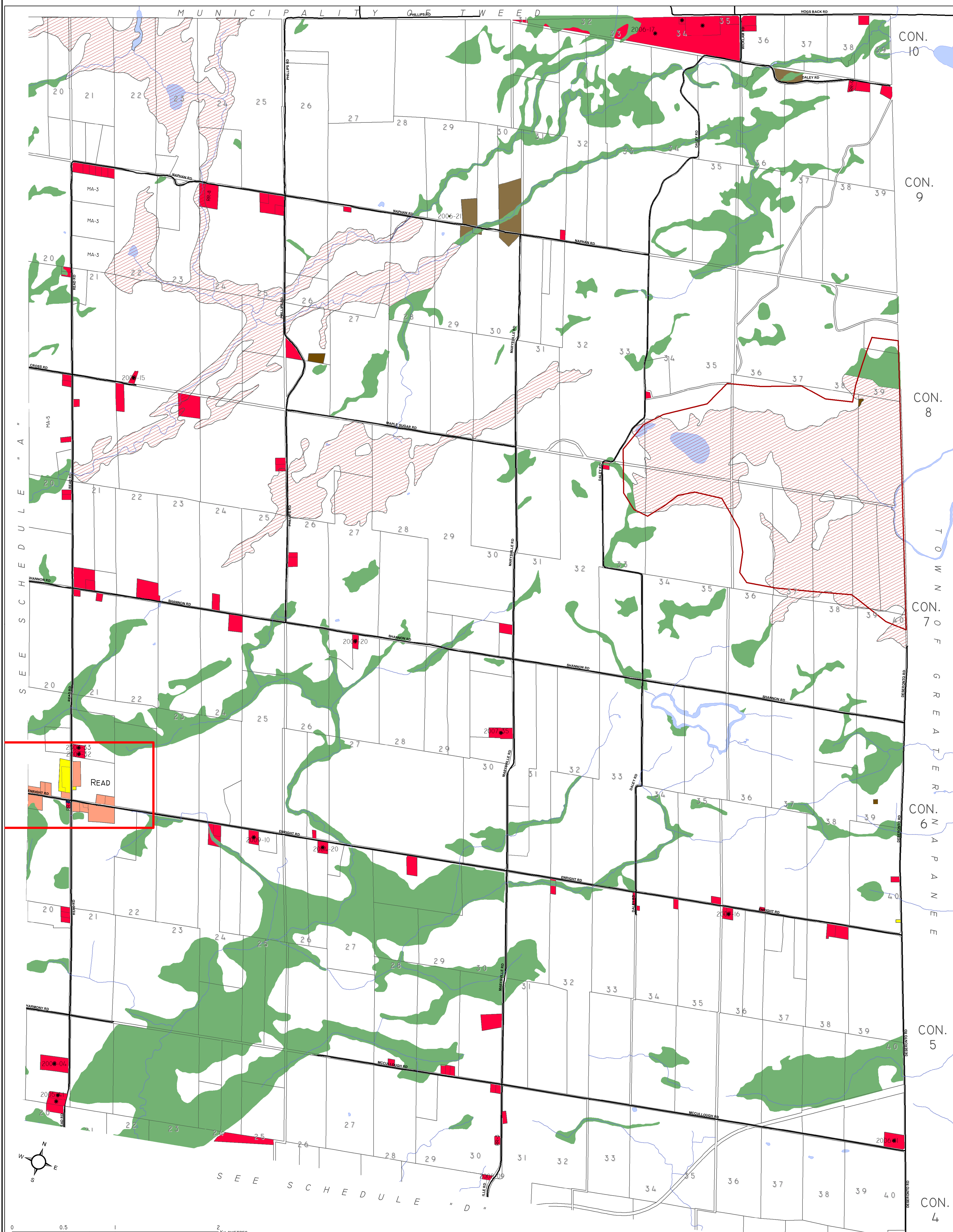
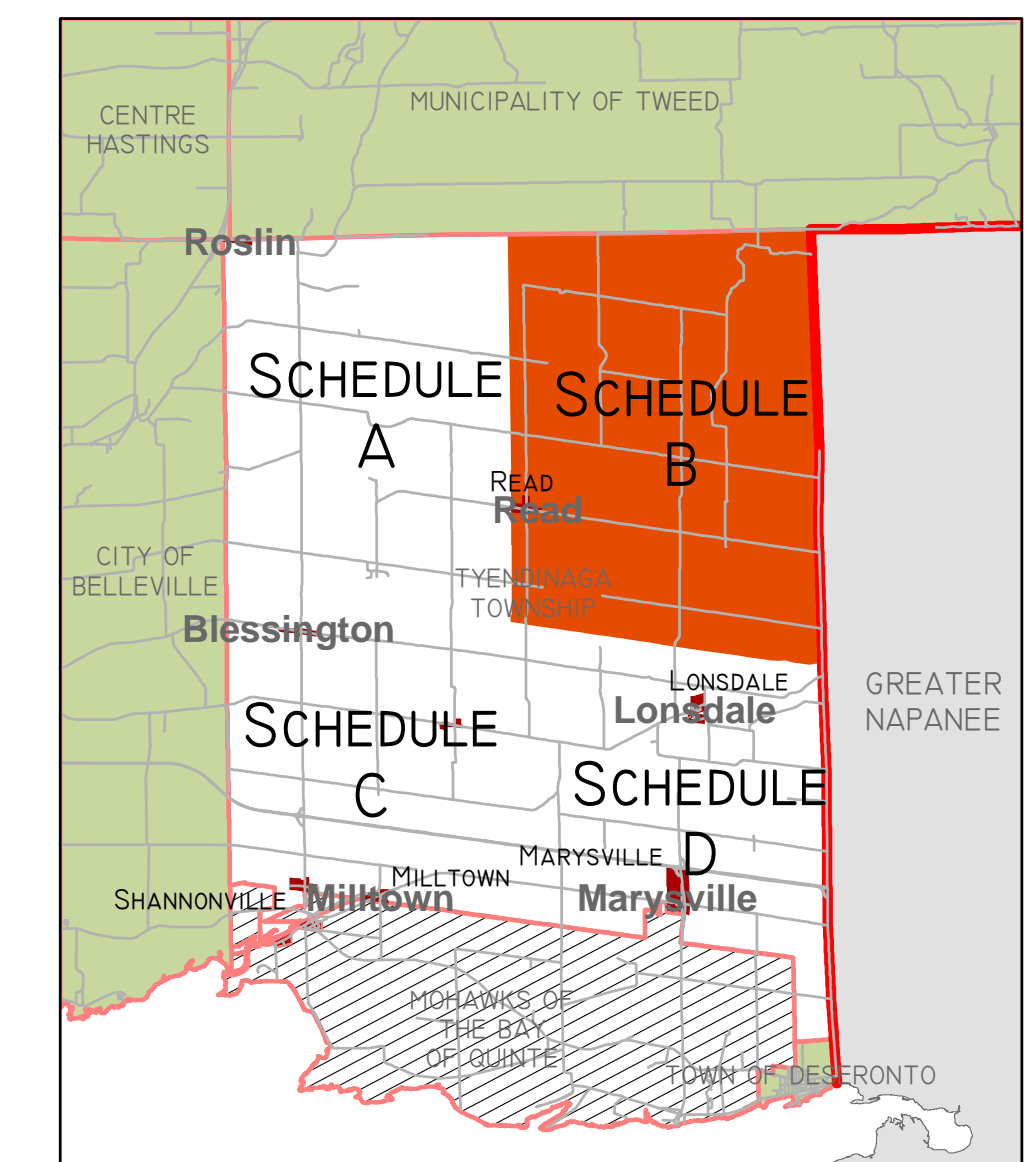

PREPARED BY TYENDINAGA TOWNSHIP & THE COUNTY OF HASTINGS PLANNING & DEVELOPMENT DEPARTMENT
PLOT DATE: MARCH 1 2010

THE COUNTY OF HASTINGS DISCLAIMS ALL RESPONSIBILITY FOR ERRORS, OMISSIONS OR INACCURACIES IN THIS PUBLICATION.

DATUM: NAD83 - UTM ZONE 18
DATA SOURCE: TOWNSHIP OF TYENDINAGA, OGDE, MPAC, AINLEY CONSULTING & THE COUNTY OF HASTINGS
FILE: G:\LAND\ZONING\CONSOLIDATION\MXD\TYENDINAGA_ZONING_2010_CONSOLIDATION_SCHEDULEC.MXD